

Smart Switch Quick Start (v1.0)

US03S

Please scan the QR code to watch the installation and setup video ,or you can access our website here.

<https://utec.life/matter/switch/guide>

Need Help?

For technical documents and more details

Please visit support.utec.life.com

Or call 1-844-439-8832

Neutral wire**Required**

About Privacy

By using your device, you agree to be bound by the UTEC Privacy Policy. Please read all applicable terms, rules, policies and usage provisions found at:

www.utec.life.com/pages/privacy

What's in the Box

Cover Panel

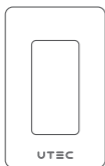

Smart Switch



Nuts Screws



Cable Label

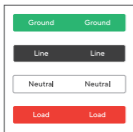





User Guide

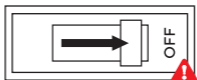

Attention

To avoid fire, shock, or death, turn off power at circuit breaker or fuse, and test that the power is off before wiring.



-  Neutral Wire is required. (Please kindly check your house wires if your house was built prior to the mid-80's.)
-  Make sure wall boxes with 18 cu in. vol. or above.
-  Need 2.4GHz Wi-Fi (Does not support 5GHz Wi-Fi).
-  Recommended loads: 1000W Max.for INC, and 600W Max.for CFL&LED.



-  Electricity can cause personal injury and property damage if handled improperly. If you are not sure about any part of these instructions, please seek professional assistance from a qualified electrician.

Product Outline

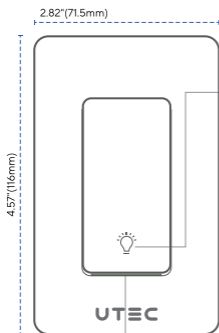

ON/OFF Button

Press to turn the switch on or off.

Reset/Configuration Mode

Press the ON/ OFF button for 10 seconds and then release it. Flash green, restored to factory settings.

Status Indicator

Solid Green

Indicate that the light is switched on.

Flash Green (Slow)

Configuration mode initiated.

Flash Green (Fast)

Connecting to WiFi.

Technical Specifications

Input:

110 ~ 130V, 60Hz

Max Load:

1000W Incandescent

600W LED&CFL

Dimensions (W x D x H)

4.2 x 1.8 x 1.4 inch
(without cover panel)

4.6 x 2.8 x 1.8 inch
(with faceplate)

Operating Temp:

14°F ~ 122°F / -10°C ~ 50°

Communication: WiFi 802.11 b/g/n 2.4 GHz

Bluetooth 5.0

Weather resistant: Indoor Use Only

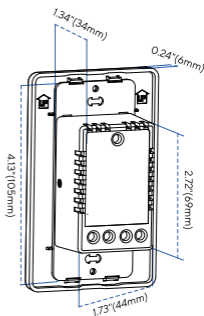

Tools you'll need



Phillips-head screwdriver



Flat-head screwdriver



Pliers

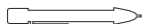

Voltage tester

⚠ WARNING: Please refer to the voltage tester guide manual, or seek professional assistance from a qualified electrician.

Installation for Single Pole

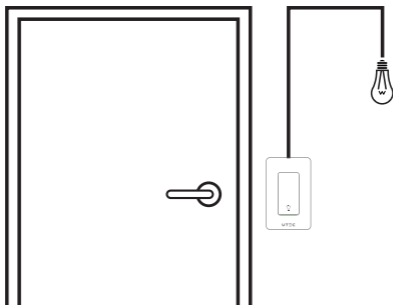

Before Installation: Turn Off Power

Turn off the power at the circuit breaker or fuse, and test that the power is off before installation.

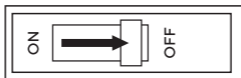

⚠ CAUTION: Compatible bulb type/max Load:
Incandescent/1000W, LED&CFL/600W. Please
check your bulb/load before installation.

STEP 1

Pull Out Old Switch

⚠ WARNING: Before pulling out, turn off power at circuit breaker or fuse, and use a voltage tester to confirm whether power is off before wiring.

Unscrew the switch plate, old switch and pull it out of the wall. **Do not remove any wires.**

STEP 2

Get to know the wires

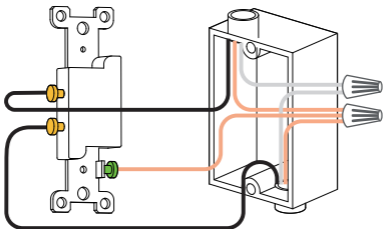

⚠ WARNING: Neutral wire is required to install the smart switch. If you can't find the neutral wire, please call an electrician for help.

Line: Usually black.

Load: Usually black, connected to the light.

Neutral: Usually white.

Ground: Usually green or copper.

STEP 3

Identify and Label “Line” wire

1. Disconnect the line and load wires from the dumb switch, then cover them with provided wire nuts for the sake of security.
2. Turn on the circuit breaker and use a voltage tester to identify the energized wire (line wire).
3. Turn off the circuit breaker and label the Line wire.

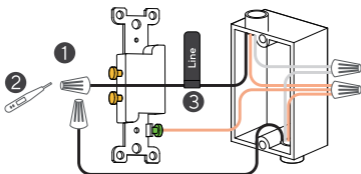

STEP 4

Label the Other Wires

Label the other wire as load wire. Label the ground and neutral wires.

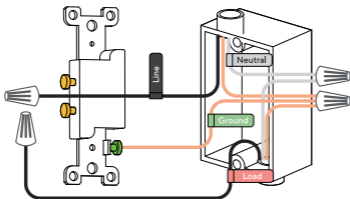

STEP 5

Take Pictures of the Wires

Take one or two pictures of the old switch and where each wire is connected to it, in case you need guidance to reverse the installation.

⚠ NOTE: Make sure all of the text on the labels in the pictures are clearly displayed.

STEP 6

Remove existing Dumb Switch

⚠ WARNING: Before removing, turn off power at circuit breaker or fuse and use a voltage tester to confirm the power is off.

Disconnect all wires and remove the dumb switch, then connect them to the smart switch.

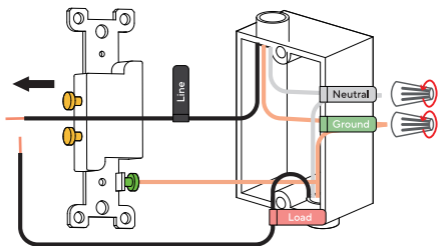



© 2025 Xthings Inc. All right reserved.

UTEC and UTEC logo are trademarks of Xthings Inc. or its affiliates registered in the U.S. and other countries and regions. All other trademarks are the property of their respective owners.

Xthings Inc. 47703 Fremont Boulevard, Fremont, CA 94538
Engineered by Xthings, assembled in China.

STEP 7

Connect the Smart Switch

Connect the wires to the smart switch.

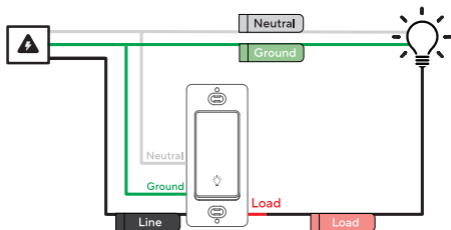

⚠ WARNING: Make sure the power is **turned OFF** before you proceed. Your existing wires may have different colors than those shown.

• Connect Neutral and Ground Wires

⚠ Note: Neutral: usually white.

Ground: usually green or copper.

Use wire nuts to connect Neutral/Ground from the outlet box to the respective NEUTRAL /GROUND from the smart switch, as show in the picture.

• Connect Line Wire

Use a wire nut to connect the labeled Line wire from the outlet box to the LINE wire coming from the smart switch.

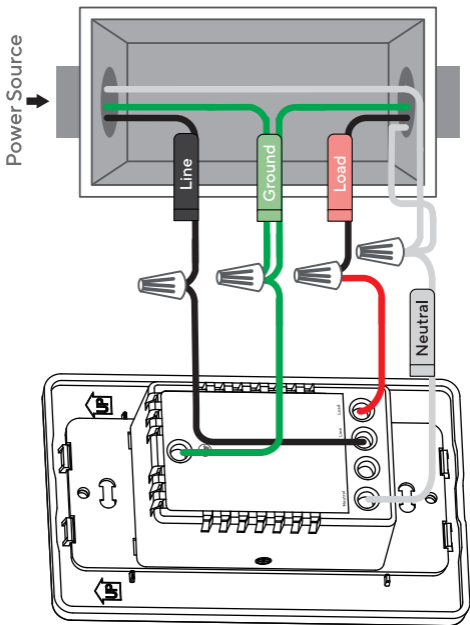

• Connect Load Wire

Use a wire nut to connect the labeled Load wire from the outlet box to the LOAD wire coming from the smart switch.

⚠ WARNING: All wires from the Smart Switch must be capped with wire nuts.

⚠ WARNING: Death or serious injury may occur if instructions are not properly followed.

STEP 8

Mount the Switch

Form all wires carefully into outlet box, and mount switch with screws supplied.

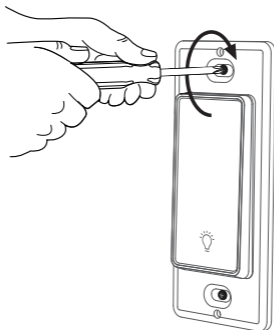

STEP 9

Turn on Power

Turn the power on at the circuit breaker.

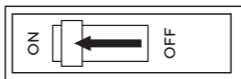

- Press the ON/OFF button on the smart switch to confirm whether the switch is powered on/off normally.

STEP 10

Snap on Cover Panel

Push cover panel onto the fixing plate and snap it into place.

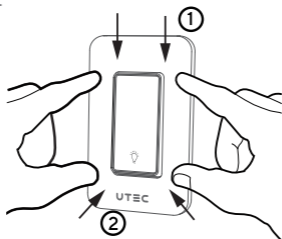

- ⚠ NOTICE:** Please turn on the smart switch first, press and hold ON/OFF for 10s to initiate configuration mode.

Set up with Matter

This is a Matter-certified device. You can integrate it into any Matter ecosystem you prefer for easy control, such as Apple Home, Alexa, Google Home and SmartThings.

Before You Start

1. Make sure you have a supported Matter controller and the associated smart home app for binding. This is required to connect and manage Matter devices on your home network. For instance, Echo Device and Alexa App, Apple Home Pod and Apple Home App, Nest Device and Google Home, SmartThings Hub and SmartThings App.

2. Connect to Wi-Fi:

Make sure your smartphone and Matter-supported controller are connected to your router's 2.4 GHz Wi-Fi. If you're not sure if your router is broadcasting a 2.4 GHz Wi-Fi connection, check with your router manufacturer or provider.

3. Take a photo of the Matter setup code for backup.

4. Matter Setup Mode: Power on the device enters the Matter setup mode, configure the app within 15 minutes of power on. If missed, simply turn your device off and then back on.

How to Set Up

*Setup processes may vary between different apps

1. Turn on Bluetooth on your phone.
2. Make sure the device enter Matter setup mode.
(Press the ON/ OFF button for 10 seconds and then release it. Flash green, the device is restored to factory settings.)
3. Open the Smart Home app and scan the Matter QR code, or enter the numeric code. Follow the instructions within the app to complete the setup.

⚠ Note: The matter QR code or enter the numeric code on the scanning sticker must be the same as that on the device to be connected to the Internet. As shown in the diagram below.

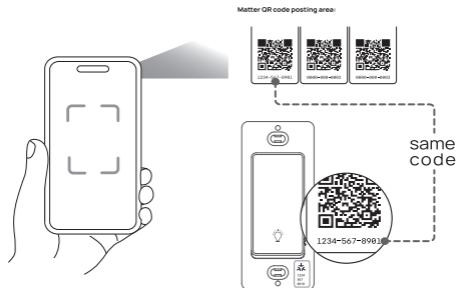

Matter QR code posting area

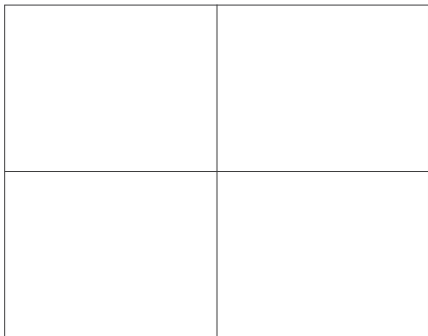

Regarding the Matter Code

The original Matter code can only be used for setup in one app (you can reuse it after a device reset).

1. If you want to integrate your device with another ecosystem after binding it to Matter. Use the Matter app to share your device with other platforms.
2. If you want to bind your device to a different ecosystem and disconnect from the current one, you should first remove the device from the app, then reset the smart switch. Reset it to factory settings and enter Matter setup mode.

FAQ

1. How to reset a smart switch to enter Matter setup mode.

Method 1: Removing via the smart home app

Method 2: Press the ON/ OFF button for 10 seconds and then release it. Flash green, restored to factory settings.

2. The device cannot be found

A. Network configuration (device is in factory default mode): Press the ON/OFF button for 10 seconds and then release it. Flash green, restored to factory settings. configure the app within 15 minutes of power on. If missed, simply turn your device off and then back on.

B. Make sure that your Matter Center (or Matter Controller, which is required to provide an ecosystem that can be paired with Matter-certified devices) and smart home application firmware are updated to support Matter.

C. Multi-ecosystem network configuration (devices are configured and shared with other gateways/APPs): Please confirm that **all** devices are in the same local area (connected to the same router) and device pairing mode is turned on.

3. Failed to add device

A. Make sure that the phone using the App is connected to 2.4G Wi-Fi and the gateway/controller is also connected to the same router.

B. You can try to restart the gateway/controller, APP or mobile phone.

4. Unable to set up the already connected Matter device with other smart home systems.

A. If your Matter-enabled device is not displayed or the pairing code cannot be created on the paired application. Please restart your Matter-certified device.

B. Do not create pairing codes in the apps of multiple smart home systems continuously. If the pairing code you created the first time is not used or has not expired, the pairing codes you create subsequently will not work.

C. Make sure to complete the setup process before the pairing code expires.

Note: In Google Home, the code expires 3 minutes after it is generated. In Apple Home, the code expires 5 minutes after it is generated. In Alexa, the code expires 15 minutes after it is generated. In Samsung SmartThings, the code expires 15 minutes after it is generated.

D. Make sure your Matter device keeps the pairing code page open in the app when you enter the numeric code (or scan the QR code) to pair with other apps.

E. If your device still cannot connect, restart your Matter Hub and Smart device. Clear the app cache and restart your phone. Then try to set up the device normally.

ISED Statement

This device contains licence-exempt transmitter(s)/receiver(s) that comply with Innovation, Science and Economic Development Canada's licence-exempt RSS(s). Operation is subject to the following two conditions:

- (1) This device may not cause interference.
- (2) This device must accept any interference, including interference that may cause undesired operation of the device.

The digital apparatus complies with Canadian CAN ICES - 3 (B)/NMB - 3(B).

This device meets the exemption from the routine evaluation limits in section 2.5 of RSS 102 and compliance with RSS 102 RF exposure, users can obtain Canadian information on RF exposure and compliance.

This equipment complies with Canada radiation exposure limits set forth for an uncontrolled environment.

This equipment should be installed and operated with minimum distance 20cm between the radiator & your body.

FCC Warning

This equipment has been tested and found to comply with the limits for a Class B digital device, pursuant to part 15 of the FCC Rules. These limits are designed to provide reasonable protection against harmful interference in a residential installation.

This equipment generates, uses and can radiate radio frequency energy and, if not installed and used in accordance with the instructions, may cause harmful interference to radio communications. However, there is no guarantee that interference will not occur in a particular installation. If this equipment does cause harmful interference to radio or television reception, which can be determined by turning the equipment off and on, the user is encouraged to try to correct the interference by one or more of the following measures:

- Reorient or relocate the receiving antenna.
- Increase the separation between the equipment and receiver.
- Connect the equipment into an outlet on a circuit different from that to which the receiver is connected.
- Consult the dealer or an experienced radio/TV technician for help.

Caution: Any changes or modifications to this device not explicitly approved by manufacturer could void your authority to operate this equipment.

This device complies with part 15 of the FCC Rules.

Operation is subject to the following two conditions: (1) This device may not cause harmful interference, and (2) This device must accept any interference received, including interference that may cause undesired operation.

The device has been evaluated to meet general RF exposure requirement. This equipment complies with FCC radiation exposure limits set forth for an uncontrolled environment. This equipment should be installed and operated with minimum distance 20cm between the radiator & your body.

IC: 29605-US03

FCC ID: 2AJZ2-US03

